

By-passing Door Sets
Top Line Grant 72-223
 up to 150 lbs/door (68 kg/door), double track
 for door thickness 1 3/8" (34.9 mm), top mount, adjustable

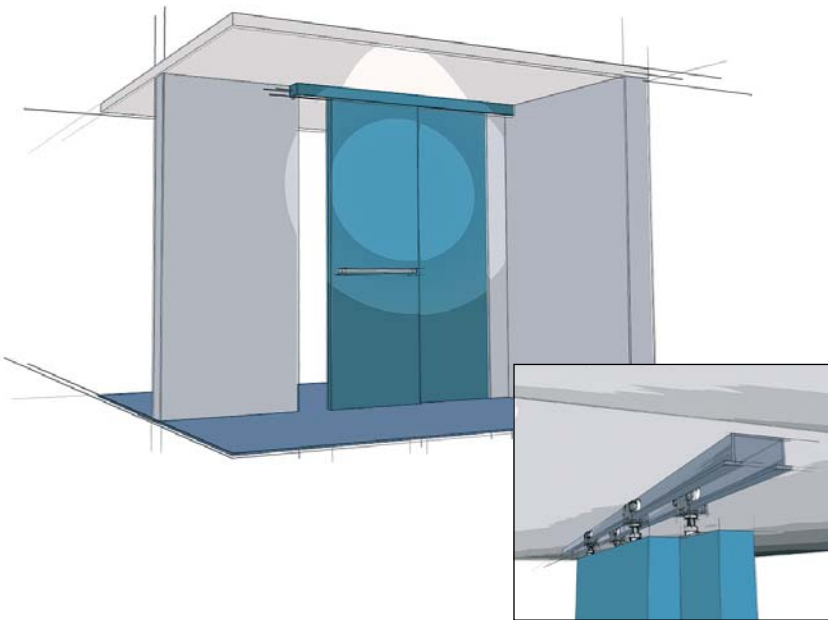

Top Line Grant 72-223

A medium duty commercial and residential grade sliding door hardware series ideal for by-passing installations. Applications include doors between rooms, closet doors, cabinets, storage walls and partitions.

- For 1 3/8" doors weighing up to 150 lbs (68 kg), optional nylon wheel carrier up to 100 lbs (45 kg)
- High quality precision ball-bearing wheels for quiet and effortless performance
- Heavy duty aluminum Double I-beam track; jump proof design
- Pivoting rocker arms ensure track-carrier contact.
- Ball and socket suspension compensates for minor header misalignment.
- Lock nut guarantees permanent positioning.
- Vertical adjustment 3/4" (19.1 mm)
- Conforms to ANSI/BHMA standards, Grade 1
- Made in USA

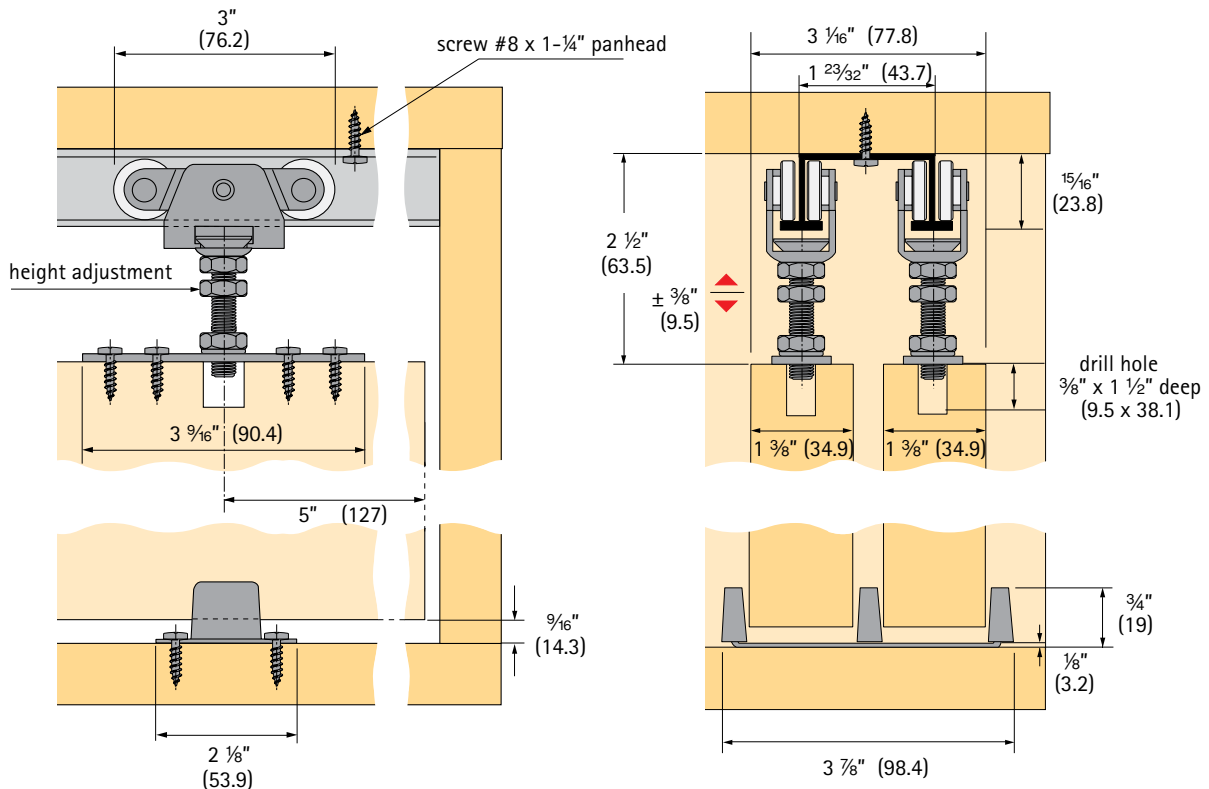

Technical specifications are subject to change without notice

Specifications:

Mounting: Top
 Adjustment: $\frac{3}{4}$ " (19.1 mm) vertical
 Door thickness: $1\frac{3}{8}$ " (34.9 mm)
 Headroom: $2\frac{1}{8}$ " (53.9 mm) min., $2\frac{7}{8}$ " (73 mm) max.
 Application: By-passing

Top Line Grant 72-223 door hardware is available in four purchasing options**Option I**

Complete package, includes track, hardware set, and all screws

Hardware and track

Length	Order no.	PU
4' (1200 mm)	113 337 4	5 sets
5' (1500 mm)	113 337 5	5 sets
6' (1800 mm)	113 337 6	5 sets
8' (2400 mm)	113 337 7	5 sets

For longer track application order hardware set and track separately

Option II

Track only

Double track 7003

Aluminum extruded, pre-drilled holes

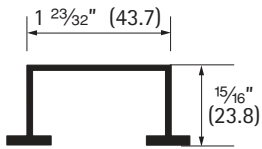

Length	Order no.	PU
4' (1200 mm)	050 533	5
5' (1500 mm)	050 534	5
6' (1800 mm)	050 535	5
8' (2400 mm)	050 536	5
10' (3000 mm)	050 537	5
12' (3600 mm)	050 538	5
16' (4800 mm)	050 539	5

Screws not included - recommend #8 Pan Head

Tracks 8' and under are notched at one end for easy access

Option III

Hardware set only

Top Line Grant 72-223 hardware set
(without track)

The hardware set includes:

- 4 carriers 7000 precision ball bearing wheels
- 4 top plates 7222
- 1 floor guide 117
- 1 wrench
- necessary screws and installation instructions

Article	Order no.	PU
Hardware set	113 337 3	10 sets

Option IV

Separate components

Top Line Grant 72-223 components**Carrier 7000 ball bearing**Steel, precision ball bearing wheels,
up to 150 lbs/door (68 kg/door)

Finish	Order no.	PU
zinc-plated	113 333 9	100

Top plate 7222with pendant bolt,
steel, adjustable

Screws included



Finish	Order no.	PU
zinc-plated	050 566	100

Floor guide 117

Steel/Nylon

Screws included



Finish	Order no.	PU
zinc-plated	050 104	50

Optional parts (not included in set)**Carrier 7000 nylon**Steel, wheel nylon,
up to 100 lbs/door (45 kg/door)

Finish	Order no.	PU
zinc-plated	113 333 8	100

Bumper stop 7014Steel, track mounted,
rubber stop, 2 required per track

Finish	Order no.	PU
zinc-plated	050 561	20